

ROAD ANGEL™

v1.0



*Product lifetime only and only with active specific subscription



PURE

Manual

Thank you for choosing Road Angel Pure Sync

Designed with safety and simplicity in mind, Pure Sync helps you stay informed of your speed and aware of changing speed limits, so you can focus on the road ahead. By combining accurate GPS technology with real-time alerts, Pure Sync acts as a reliable driving companion—supporting safer journeys, reducing the risk of speeding penalties, and giving you extra peace of mind behind the wheel.

This manual will guide you through setup, daily use, and key features, ensuring you get the most from your device. Whether you're a new or experienced driver, the following pages will help you understand how to operate the device with confidence.

Drive safe, stay aware, and enjoy the journey.

Road Angel Pure Sync requires a subscription to provide full functionality. The subscription provides all the great features from the alerts database, road speed library and smart motorways live updates, which provides real time variable speed limit information to Pure Sync.

To purchase a subscription package, access your account at the Road Angel website: **<https://www.roadangelgroup.com>** or call **0330 320 3030**

PURE

Contents

Manual.....	2
Contents Page.....	3
What's in the box	4
Getting Started	5-8
Road Angel App.....	9-10
Connecting	11-14
Application.....	
Tutorial	15
Devices Overview	16
Subscription.....	17
Vehicle Settings	18
Device Settings.....	19
Select Device	20
Preset Device Settings.....	21
Sound & Alerts.....	22-25
Display Settings	26
Unit	27
Interface.....	
Introduction	28-29
Alerts	30-34
Device Sharing	35-37
Device Information.....	38
Device Reset.....	39
Firmware Update	40-41

What's in the box

Pure Sync is supplied with everything you need to get started

The Pure Sync unit, a dashboard mount, a USB car power adapter and a USB A to USB C power cable.



Getting Started¹

Pure Sync App Download

Pure Sync requires a subscription to operate correctly and is driven by an accompanying smartphone APP. Start by scanning the QR code, that is displayed as a sticker on the Pure Sync unit, on the Pure Sync box and in the accompanying documentation. All QR codes will direct you to the road angel website.



Getting Started²

Create an Account

First create an account or log-in with your existing credentials.

If you create an account, then you will need to confirm your e-mail address by clicking the link in the confirmation e-mail that is sent to you, BEFORE you can log in. (Note that two e-mails are sent, one is a welcome message and the other contains the confirmation link).

Take care to record your user name and password as it is required to login to the APP.

See our 3,044 reviews on ★ Trustpilot

ROAD ANGEL™

Create your account

Please fill the form below to create account

First name

Last name

+44 7400 123456

E-mail

Password

Password must include:

- ✗ At least 8 characters
- ✗ Uppercase letter
- ✗ Lowercase letter
- ✗ Number
- ✗ Special character

Strength: Weak

☐ By creating an account, you agree to our [Terms & Conditions](#).

See our 3,044 reviews on ★ Trustpilot

ROAD ANGEL™

Please check your inbox for the activation email – you'll need to confirm your account before you can log in.

Login

Please enter your e-mail and password:

E-mail

Password [Forgot password?](#)

LOGIN

New customer? [Create an account](#)

Please use the forgot password link if you are having issues logging in. If you are still having issues, please call Road Angel on **0330 320 3030**.

Getting Started³

Register your Device

Follow the instructions on the website to register your device.

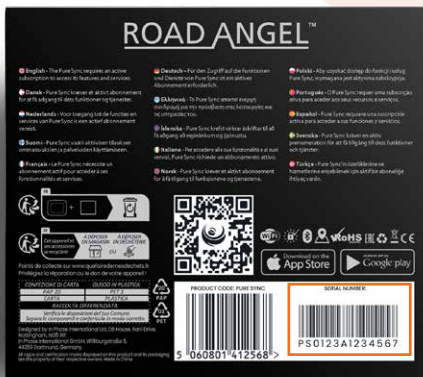

The serial number for Pure Sync can be found on the back of the box. It is also found on Pure Sync when it is put into pairing mode.



The website will then guide you through the subscription purchase or activation process.

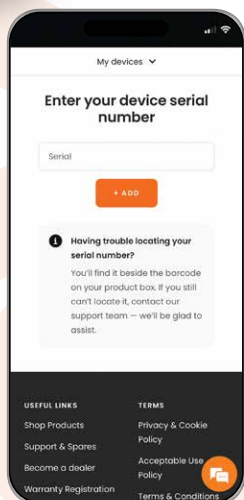

Getting Started⁴

Downloading the App

Once the website reports that Pure Sync's subscription is active, it is time to download the APP from the Apple App Store[®] or Google Play Store[®] if you haven't already.

When the APP has been loaded then Pure Sync can be paired with the APP.

https://play.google.com/store/apps/details?id=com.roadangelgroup.app&hl=en_IE

<https://apps.apple.com/gb/app/road-angel/id1474824482>.

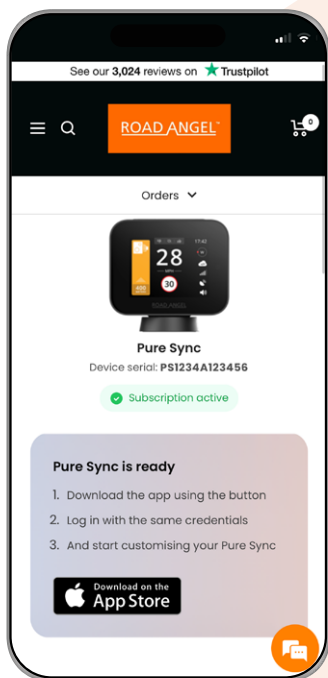

Road Angel App¹

Permissions

Note: It is important when pairing to perform it in an area where there is a good data signal or wireless network as the app needs to know the serial number of the Sync unit, which it reads from your Road Angel account.

Please allow Bluetooth and Location permissions as Pure Sync will not function without them. Pure Sync is controlled by the Road Angel APP.

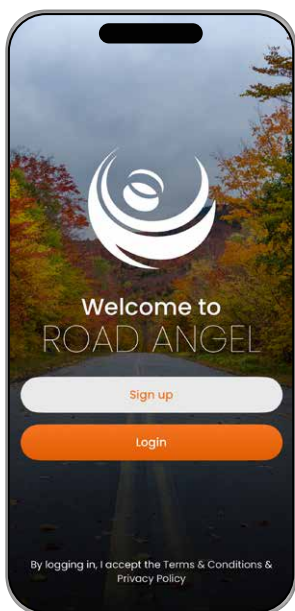

Login to the Road Angel APP using your account credentials when registering with the website.

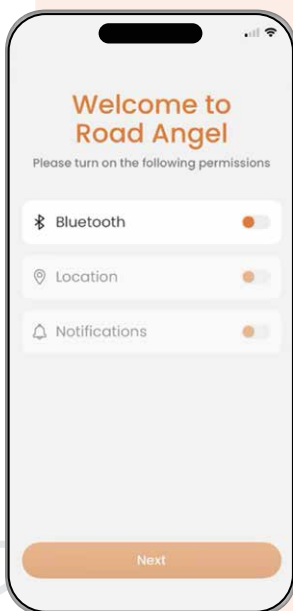

After signing in and acknowledging the welcome message, on first install only you will be asked to turn on Bluetooth, location and notifications permissions.

Road Angel App²

Location Services

Switch on all of the permissions and select allow for Bluetooth, Allow While Using App for Location and then Change to Always Allow when prompted.

You can choose whether to accept notifications from the APP, but it is recommended to allow them.

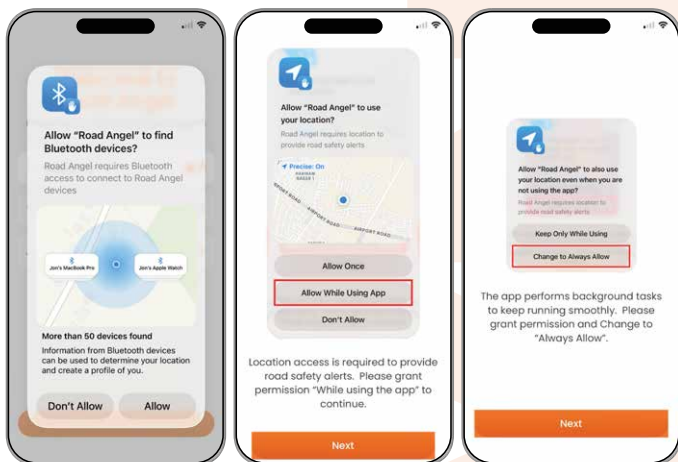

When you enter the APP you will see Pure Sync in your account with a note that says active next to it. The active note indicates whether your subscription is detected by the system.

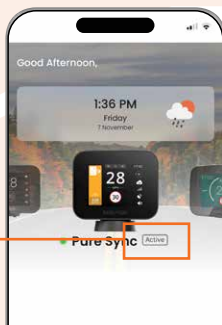

Connecting¹

Powering up the Pure Sync

Power up Pure Sync by connecting it to a power supply using the USB C to USB A cable.



Connecting²

Pairing the Pure Sync

The Pure Sync will power up and at first power on will display the QR code for the website.



Press the right button to remove this from the screen, at which point you should see the device serial number displayed as shown in the APP.



Press and hold the right button for 3 seconds to put Pure Sync into pairing mode and then press Bluetooth Sync in the APP.

Connecting³

Pairing the Pure Sync Cont.

The device should appear in the list as its serial number PSXXXXXXXXXX. If it does not appear they select retry.

Select the device and then press Start Pairing.

If the device does not appear, there are a number of reasons for this:

1. Check that Bluetooth is enabled on your phone.
2. Switch Bluetooth on and off, if enabled and select Retry.
3. Check that Sync is powered on and put into pairing mode.
4. Check that you have a good data connection to your phone as the APP needs to know the serial number of Sync to pair with it correctly.



If the device still does not appear check that the serial number of your device matches the serial number in your account, otherwise call customer service on 0330 320 3030.

Connecting⁴

Pairing the Pure Sync Cont.



When the Pure Sync is in pairing mode, the middle button of the Pure Sync will flash blue.



Pure Sync can sometimes report successful pairings some time before the app does.



It is important that the "setup complete" screen is shown; you will need to wait and press "Go to Home" to complete the setup.



Not waiting can result in an incomplete pairing; the user will need to "re-pair".

App – Tutorial

Tutorial to Pure Sync's Main Features

When Pure Sync has been paired successfully for the first time, then the app will offer a quick tutorial that highlights the main features of the APP.

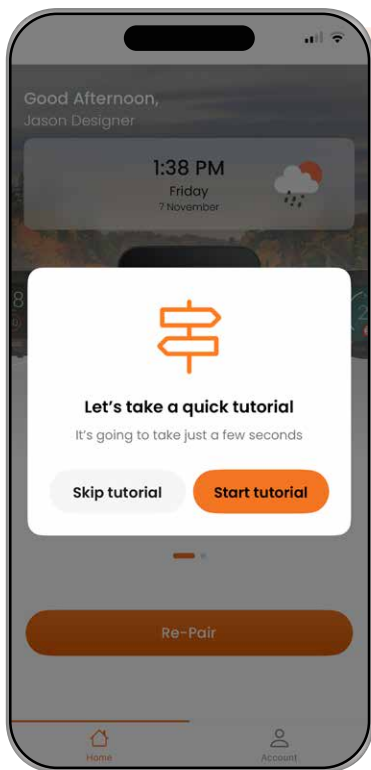

Press Start tutorial to be guided through Pure Syncs features or Skip tutorial to skip it.

App – Devices Overview

Pure Sync Overview Status

When the device is paired 4 status icons are displayed on the home screen below the Pure Sync image in the device carousel.

The **Bluetooth** icon denotes the connection status between the APP and the Pure Sync device.

The **subscription** icon denotes whether a subscription has been activated and detected by the account. If you click on the icon the APP will inform you of the expiry date of the subscription.

My vehicle allows you to enter the details of the vehicle that you own.

Clicking on **settings** will give access to the Pure Sync Device settings page.

Warranty Expires on indicates the expiry of your warranty. This will either be one year from date of registration or at the expiry of your current subscription, whichever is later.

View User Guide, clicking this icon downloads this guide.

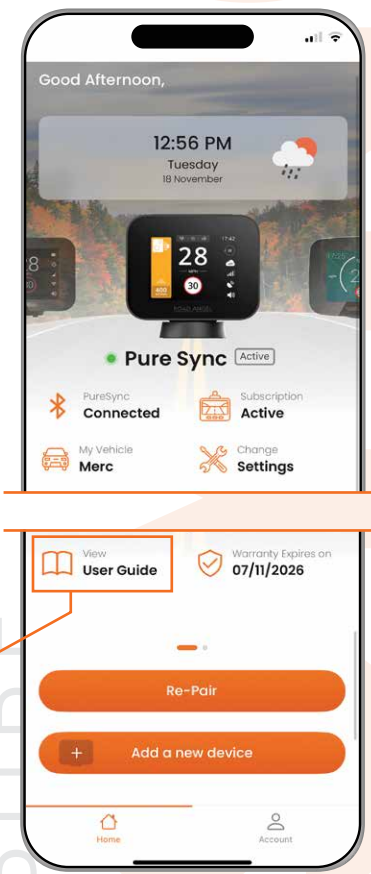

App – Subscription

Subscription Status

Clicking on Subscription on the home page displays the description status, and the expiry date.

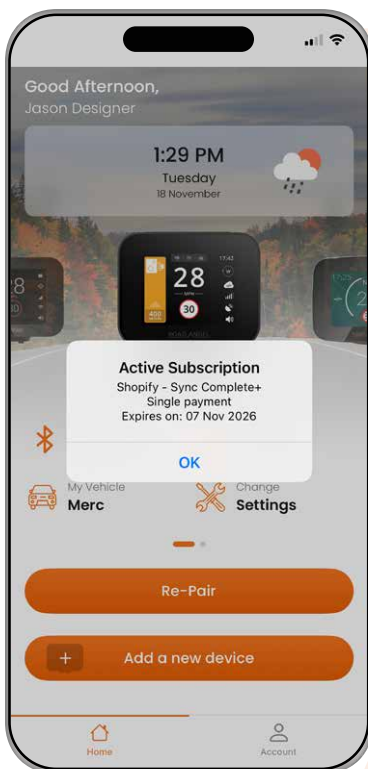

App – Vehicle Settings

Vehicle Specifics

Vehicle settings has two benefits for users. It allows the setting of vehicle type so that Sync raises the correct speed limit, which can sometimes depend on vehicle type. It also allows users with more than one Sync to label them in the app according to where Sync is placed.

Clicking on My vehicle opens the Vehicle Settings menu.

Clicking on Vehicle Settings in the Device Settings page also accesses the Vehicle Settings page.

- Select Speed Unit to choose between MPH and KPH.
- Select Vehicle Type to select from the following:
 - Car, Towing.
 - Light goods vehicle.
 - Heavy goods vehicle.
 - Light motor home.
 - Heavy motor home.
 - Short bus.
- Under Name enter a nickname for the car where you intend to use Pure Sync.
- Under Plate the registration can be entered.
- Under model enter the model of car owned.
- Under make enter the make of car owned.

The screenshot shows the 'Vehicle Settings' screen of an app. At the top, there's a back arrow and the title 'Vehicle Settings'. Below this is a section 'Set your Vehicle Settings' with an orange car icon. There are two settings: 'Speed Unit' (Current: MPH) and 'Vehicle Type' (Current: Car). Below these is a section 'MY VEHICLE INFORMATION' with four input fields: 'Name' (containing 'Merc'), 'Plate' (containing 'PJS'), 'Model' (containing 'GLA 250'), and 'Make' (containing 'Mercedes'). At the bottom of this section is an orange 'Save & Update' button. The app has a bottom navigation bar with 'Home' and 'Account' icons.

App – Device Settings

Customise Device Settings

Clicking on settings on the home page takes you to the settings page.

This is the area that allows you to customize the device to your own preferences.

The icon at the top and the name in Choose Device displays which device you are customising.

- **Choose Device** – Change the device you're customising.
- **Preset Profile** – Quick access to common settings.
- **Vehicle Settings** – Another route to the vehicle settings page.
- **Sounds & Alerts** – Assign sounds to alerts and configure each alert.
- **Display Settings** – Customise Pure Sync's UI.
- **Device Sharing** – Share Pure Sync with up to three others.
- **Family Sharing Priority** – Set user connection order in the vehicle.
- **Device Info** – View device details.
- **Firmware Update** – Check and update firmware OTA.
- **Reset Settings** – Restore defaults without removing pairing.
- **Factory Reset** – Restore defaults and remove pairing.
- **Delete Device** – Remove Pure Sync from your account.

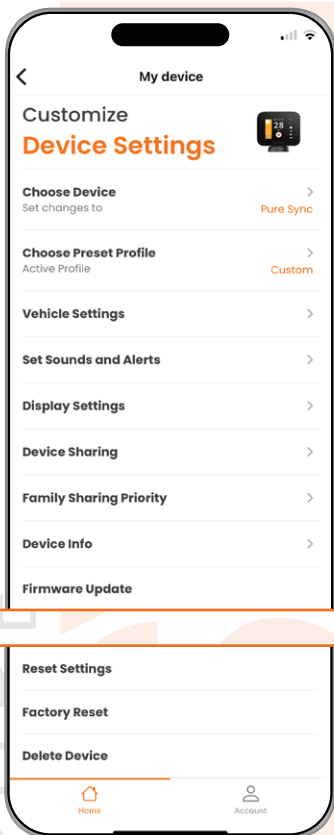

App – Select Device

Choose Device Menu

The Choose Device menu allows you to switch between device types and also displays the serial number of all the Road Angel devices that you own.

Click on the icon to choose the device for which you want to customise the settings.

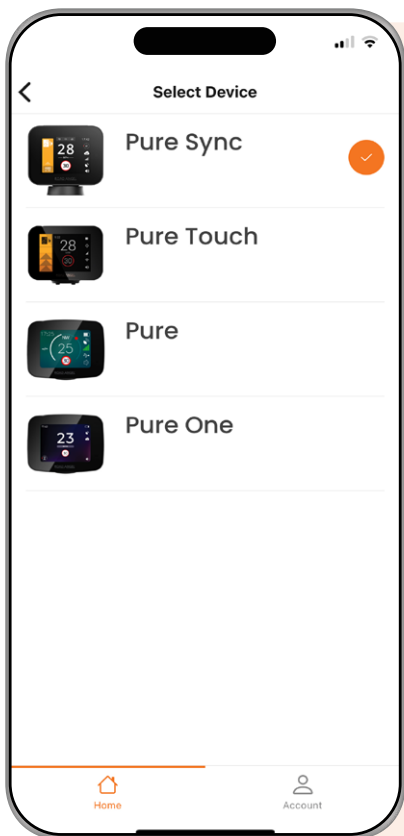

App – Preset Device Settings

Drive Selection Settings

Choose from the following presets:

- **SafeDrive** – which turns on all the alerts apart from School Zone.
- **SmartDrive** – which turns off Black Spot Alerts, School Zones and Congestion Zones.
- **ProDrive** – which turns off Level Crossing with Camera, School Zones and Congestion Zones.

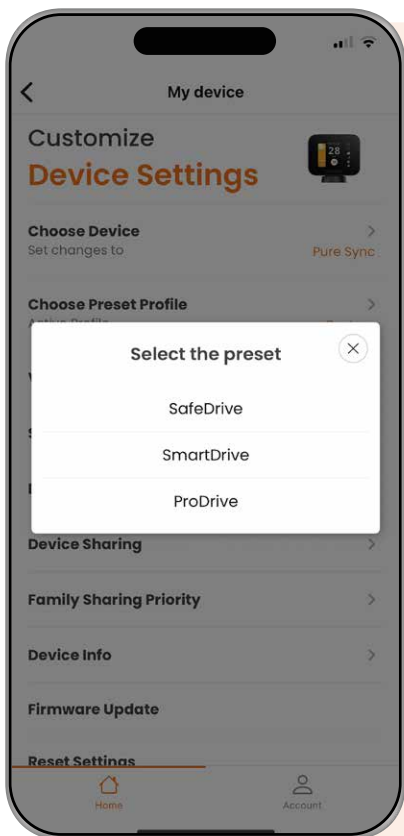

App – Sounds & Alerts¹

Customise Individual Alerts and Sounds

This menu allows you to turn individual alerts on or off. Set the sound level and customise sounds for individual alerts or globally.

Global Sounds allows you to assign voice and beep options and set the volume for ALL alerts. NOTE: If you want to set sound options individually for alerts then Global Sounds must be turned OFF.

Intelligent Mute is a setting that can be configured for each alert individually. It configures Pure Sync to only warn you for speed alerts if your speed exceeds the limit by a certain threshold as set by intelligent mute. It can be set to -10%, 0%, +5% or +10%. For example on normal roads you might set to 0% but when a fixed safety camera alert is raised you might set to -10%.

- **Global Sounds** – use the toggle to set global sounds on or off.
- **Welcome message** – use the toggle to set the welcome message on or off.
- **Volume** – Slide the volume control to set it between 0% and 100%.
- **Beep options** – choose between: Off, Alert, Bop Dip (default), Click 1, Click 2, Click 3, 999, Bell, Classic Alert, Classic Button, Classic Over Speed, Click, Dit, High Beep, Laser Blast, Peeow, Pop 1, Pop 2, Siren, Squeak, Tink and Warble.

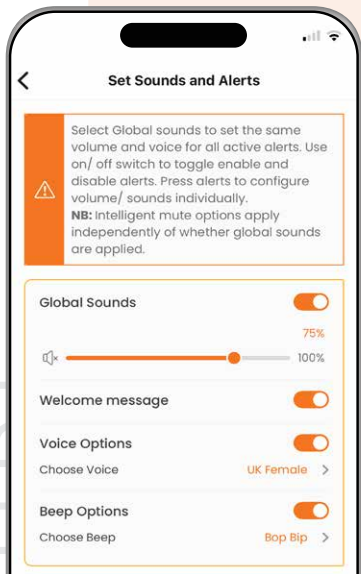

App – Sounds & Alerts²

Customise Individual Alerts and Sounds Cont.

At the bottom of the page, each individual alert can be toggled on or off.

The following icons can be selected to set sound type and levels; configure intelligent mute (see page 25); and set the distance from which an alert is raised:

- Camera Van Location, Red Light with Speed Camera, Fixed Camera, Average Speed Camera, Overspeed.

The following icons can be selected to set sound type and levels; and set the distance from which an alert is raised:

- Bus Lane Camera, Red Light – No Speed Camera, Level Crossing with Camera, Blackspot, School Zone, Congestion Zone, Lane Closures, Traffic Congestion, Roadworks and Accident.

- Speed Sensitive Distance is a setting which doubles the distance an alert is raised if the vehicle is travelling at high speed.

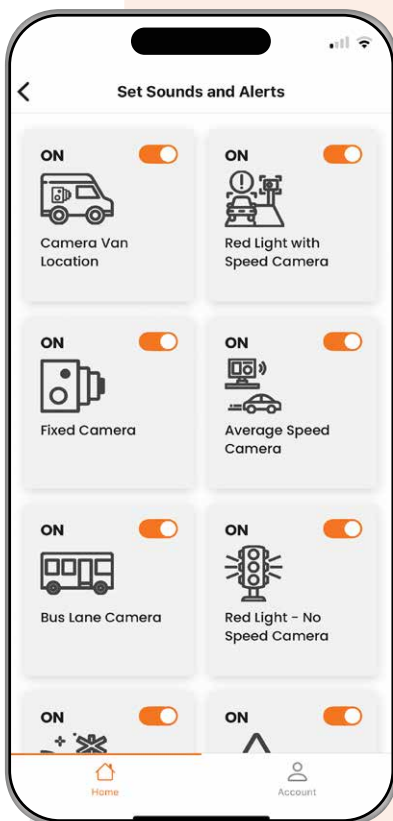

App – Sounds & Alerts³

Individual Alert Configurations

Selecting one of the icons gives a sub menu that is similar for all types of alert. Some alerts do not contain intelligent mute settings (see page 25) because they are not relevant for that alert.

- Alert distance, drag the slider to set the distance that you want an alert to be raised.
- **Beep options:** Drag the slider to set the alert volume for overspeed for this particular alert.
- **Choose Beep:** Select from Off, Alert, Bop Dip (default), Click 1, Click 2, Click 3, 999, Bell, Classic Alert, Classic Button, Classic Over Speed, Clink, Dit, High Beep, Laser Blast, Peeow, Pop 1, Pop 2, Siren, Squeak, Tink and Warble.
- **Play Sound:** Select this control for a preview of the sound you have selected.

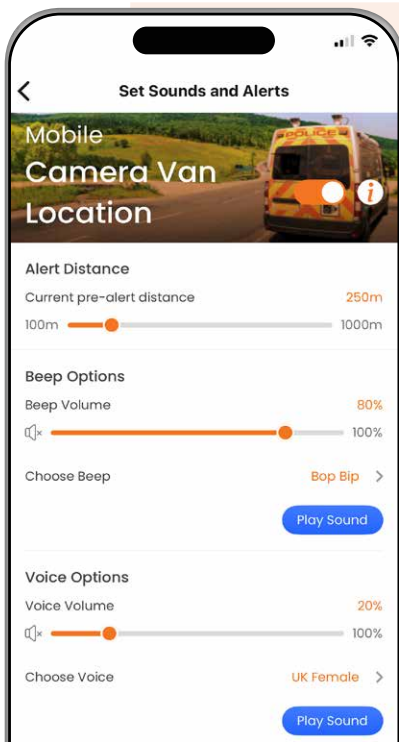

App – Sounds & Alerts⁴

Individual Alert Configurations Cont.

Intelligent Mute: Pure Sync contains a function known as intelligent mute. This mutes all sound unless you are approaching a hazard and are exceeding the speed limit, when it will sound a beep. The mute can be modified further by setting a threshold where the beep will not sound unless it is exceeded.

Choose from -10%, 0%, +5% and +10%

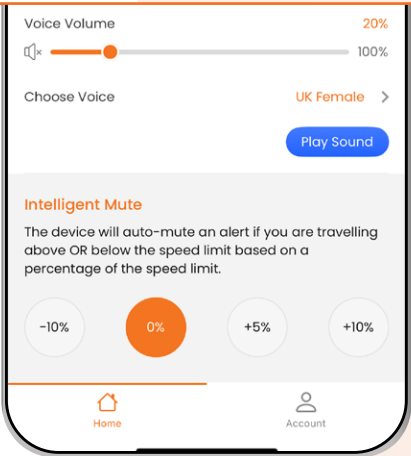

App – Display Settings

Customise the User Interface

Display Settings allows the user to choose the appearance of the user interface on the Pure Sync device.

As a default screen brightness is set to automatic, text is normal and the info bar and top bar are off, which gives a clean focussed appearance.

Brightness

- **Auto:** Use the toggle to set this on or off. On automatically sets the brightness of the screen in response to detection from the light sensor by the side of the screen. In bright sunlight the screen is brighter and in darkness it is dimmer.
- Use the slider to manually set the brightness.
- **Bold text:** Use the toggle to select bold or normal text.
- **Info Bar:** Use the toggle to permanently turn on or off the information in the side bar.
- **Top bar:** Use the toggle to turn on the button bar at the top of the Sync user interface.

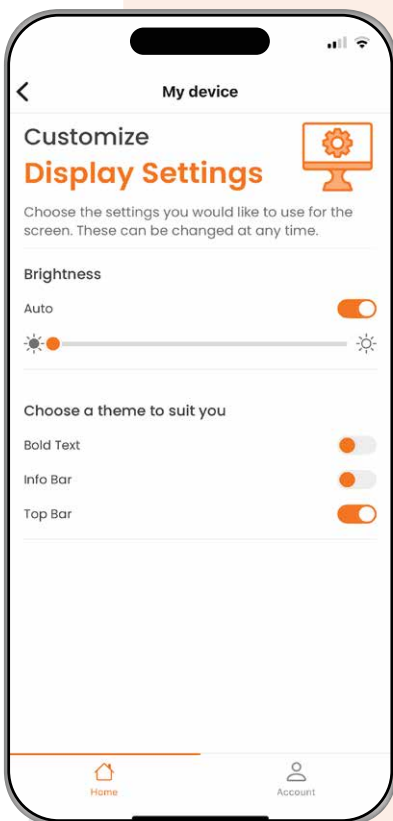

Unit

Introduction

Pure Sync consists of a main unit and mounting unit. The mounting unit and main unit are joined by strong magnets and joining them enables a power connection.

The unit is powered by a USB C 5V connection, which can be plugged into the back of the mount or directly into the back of the main unit.

There are three buttons on the top of the unit. All three buttons have context sensitive multiple functions and are back lit to emphasise their function.

The **left button** is for raising new alerts, reporting errors and confirming live camera vans as well as for navigating the user interface.

The **central button** flashes blue when Sync is in Bluetooth pairing mode and also controls the sound status cycling through: sound on, mute and intelligent mute.

The **right button** is used to put Pure Sync into Bluetooth pairing mode and for navigating the user interface.



Interface – Introduction¹

Once paired the screen defaults to top bar on and info bar off. For a cleaner interface switch off the top bar (see page 26).

If the top bar is switched off, the top bar icons appear temporarily when the buttons are pressed.

The top number is your current speed and the number in the red circle is the speed limit.

If you exceed the speed limit, Sync will raise an audible beep and the screen will turn red to warn you that you are speeding.

Sync allows the appearance on the user interface to be modified.

The icons in the top bar show what happens when pressing a button.

When there is a + on the left hand button, you are able to report an alert that has not been raised. It is followed by a confirmation screen, which asks you to confirm the alert by pressing the left key again.



Interface – Introduction²

The centre button allows you to switch between sound modes, on, mute and intelligent mute. If you long press the centre key it powers off the device.



The right button goes to the settings page.



The settings page will display firmware versions.



Interface – Alerts¹

Alerts Interface

If an alert is raised it is placed on the left side of the user interface. The symbol shows the type of alert and the approximate distance to the alert. If the speaker is enabled Pure Sync will also give an audible warning, e.g “Warning, fixed safety camera ahead, speed limit 30”).

Note that the left button icon has changed. If this alert has been raised incorrectly then you can report it by pressing the left key. You will be asked to confirm the error by pressing the key again.



A full list of alerts can be found in the alert settings section of this manual.

Interface – Alerts²

Alerts Interface

If the info bar has been turned on in display settings (see page 26), then diagnostic icons will appear on the right side of the screen.



1. The top icon shows the time.
2. The second icon shows a compass. The letter represents the direction, and the red dot the location of north.
3. The third icon shows whether you are connected to the internet so that you can access the road speed library and alerts database.
4. The fourth icon shows whether your phone is connected. Pure Sync only requires low data rates to function correctly so any bars showing should be enough to provide data.
5. The fifth icon shows whether SYNC has access to satellite data.
6. The last icon shows the sound status.

Interface – Alerts³

Smart Motorway Notifications

If you see a black circle for the speed limit this indicates that a variable speed limit is in force. Please pay attention to the matrix signs on the road.

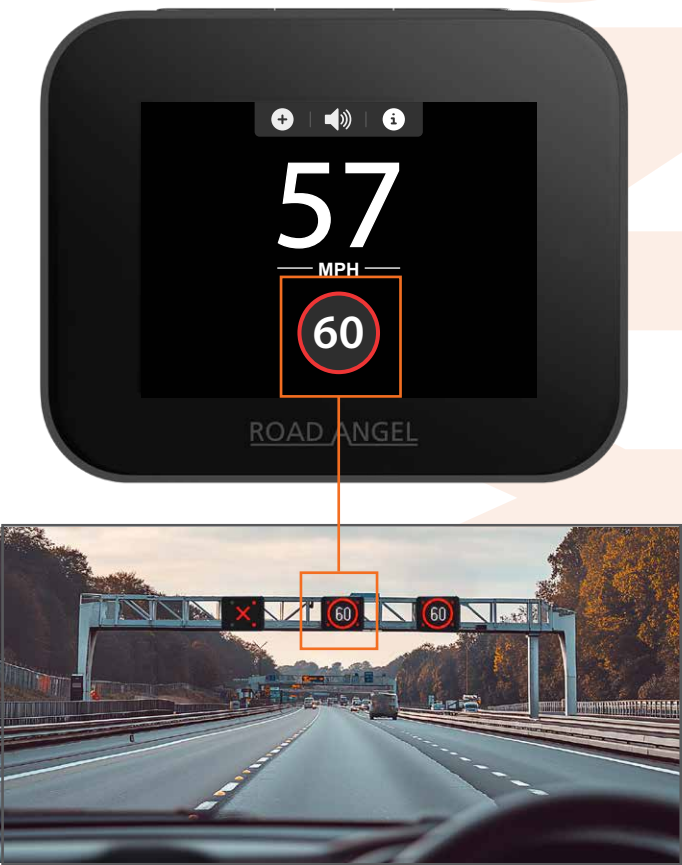

Interface – Alerts⁴

Default User Interface Cont.

On the left hand side of the screen alerts appear. The following symbols have the following meanings:



Camera Van Location –

Possible location of a mobile safety camera van as reported in the past. The location may not have been used for some time.



Live Camera Van Location – A road angel user has spotted a mobile safety camera van and reported it as live. The live alert stays triggered for all users for 2 hours after the initial report.



Red Light with Speed Camera – This is a dual camera positioned at traffic lights and detects vehicles passing through on red or speeding.



Average Speed Camera – This is a set of cameras that determine average speed across a zone. Pure Sync reports your average speed across the zone. Some zones have reset cameras that restart the measurement of average speed. Pure Sync detects these reset cameras and reports your average speed in each individual enforcement zone in the same way.



Bus Lane Camera – These cameras detect if you are driving in a bus lane. Pure Sync does not determine any time restrictions on bus lanes and alerts you to the presence of the camera.



Red Light – No Speed Camera – A camera positioned at traffic lights that detects vehicles passing through on red.



Level Crossing with Camera – Some level crossings do not have gates but do contain a camera to detect if warning lights are ignored.



Interface – Alerts⁵

Default User Interface Cont.



Blackspot – Alerts you to an area in the road that has previously been designated as an accident black spot.



School Zone – School Zone alerts are based on post code information supplied by government. It does not indicate whether a reduced speed zone is in effect for a particular school, nor does it indicate that a school is necessarily on the road on which you are travelling. Instead it alerts you that you are close to a school and that there may be school children, young mothers with pre-school children, extra traffic for the school run, etc in the surrounding area and that you need to take extra care.



Congestion Zone – Warns the user that they are approaching a Congestion Charge Zone, for example as found in the Greater London area.



Lane Closures – Warns the user that a lane has been closed on a major road or motorway with matrix signs.



Traffic Congestion – Warns the user that there is traffic congestion on a major road or motorway with matrix signs.



Roadworks – Warns the user that there are roadworks on a major road or motorway with matrix signs.



Accident – Warns the user that there are roadworks on a major road or motorway with matrix signs.

Device Sharing¹

Set Up Device Sharing or Family Sharing

Device Sharing or Family Sharing allows you to share your Pure Sync & its Subscription with up to 4 other users.

In order to be able to share your Pure Sync with a friend or family member, they need to create a Road Angel account before they can become a family user of Pure Sync.

This is particularly useful for friends and family who might share the car that contains Pure Sync.

Pure Sync will keep the settings that the main user has allocated to the device and connect to the phone with the highest priority, as defined by the main user of Pure Sync.

Here is a step-by-step guide on how to share your Pure Sync.

Before you begin, you must have already set up/onboarded and subscribed your Pure Sync successfully.

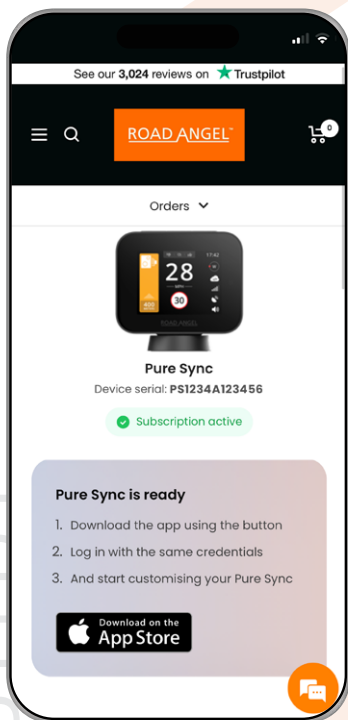

Device Sharing²

Set Up Device Sharing or Family Sharing Cont.

1. Get the family member or friend you want to share the Pure Sync with to create an account on the Road Angel website at Roadangelgroup.com.
2. Click Add e-mail address and enter the family member's e-mail address.
3. Click save to add the device (ensure you do not use capital letters).
4. The APP will check that the user exists and it so will add it to the list. (up to three additional users can be added).
5. The family user will be sent an email to acknowledge that they want to share a Pure SYNC unit. Please follow the instructions in the email and click the link to activate family sharing for the family member's account.
6. When the family member opens the Road Angel app it should appear in the home screen. If Pure Sync is not shown please ring customer service for assistance on 0330 320 3030

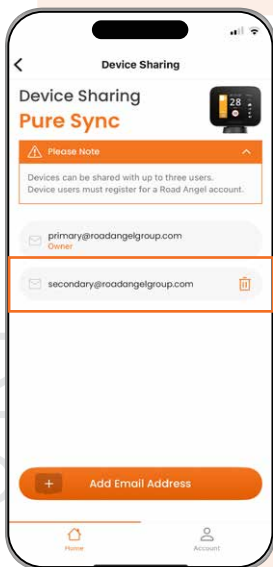
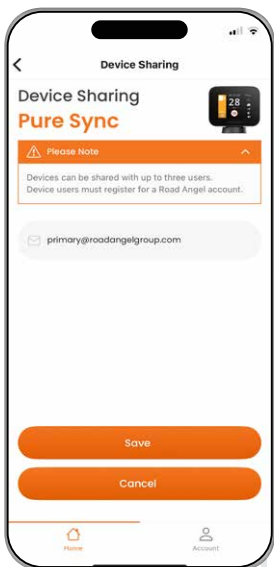

Device Sharing³

Set Up Device Sharing or Family Sharing

Family sharing priority allows you to configure who's phone connects to Pure Sync in priority order if you are both in the same car. Note that this menu can only be accessed if you are connected to Pure Sync and the family member has previously paired to Pure Sync.

To change the priority drag the email address into the order in the list that you want priority to take and select Update Priority to confirm the change.

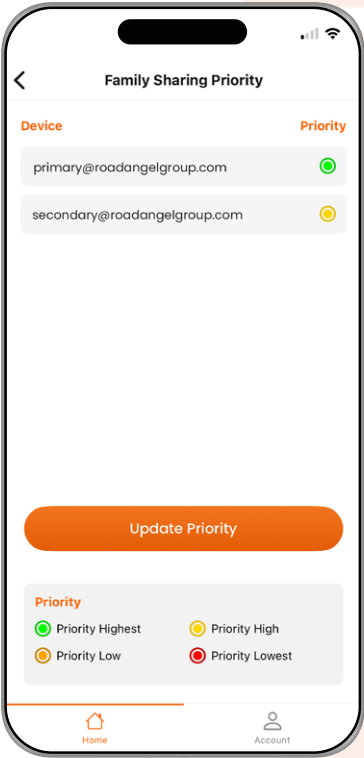

Device Information

Set Up Device Sharing or Family Sharing

This screen gives details of information about your Pure Sync and is useful if you call customer services with a query. Customer services may direct you to this screen to be able to answer any questions you might have about Pure Sync.

- **Serial ID** – reports the serial number of your Pure Sync unit.
- **Firmware version:** to reduce download times, Pure Sync’s firmware is divided into three parts: Main, which concerns the control program of Pure Sync, UI, which concerns the user interface of Pure Sync, and Audio version, which contains the sound files.
- **Database** – this will allow customer service to confirm that your app has access to the latest maps.
- **Mac address** – this setting confirms the MAC address of your device. Last Connected, reports when you last started a connection with Pure Sync.
- **Warranty Expires on:** Reports when the warranty expires.

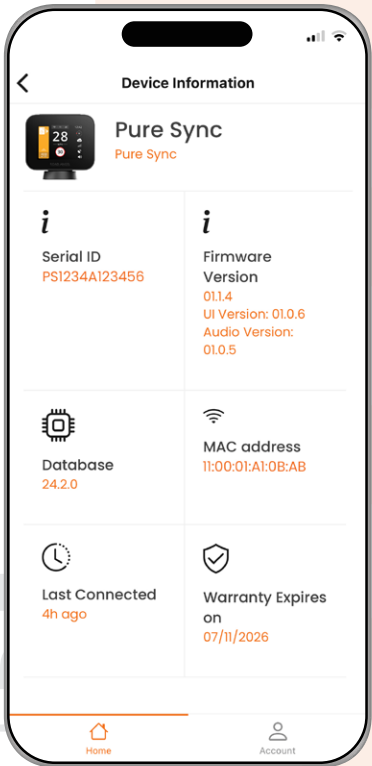

Device Reset

Reset Settings, Factory Reset and Delete Device

A warning box is raised for you to Cancel or Confirm on all 3 reset options.

Reset Settings



Selecting Reset Settings sets all alert settings, sounds screens etc back to the default settings.

Factory Reset



Selecting Factory Reset, sets all alert settings, sounds screens etc back to the default settings. It also removes all pairing information.

Delete Device



Selecting Delete Device, removes Pure Sync from your Road Angel account.

Firmware Update¹

Check and Action Updates

Select firmware update to check if there are any firmware updates available.

If available you will be prompted to start updating the firmware.

To reduce download times, Pure Sync's firmware is divided into three parts: Main, which concerns the control program of Pure Sync, UI, which concerns the user interface of Pure Sync, and Audio version, which contains the sound files.

- Main firmware updates take approximately 1 minute to update.
- UI firmware updates take approximately 6 minutes to update.
- Audio firmware updates take approximately 12 minutes to update.

The updates are performed via Bluetooth connection and therefore the Pure Sync and phone must remain powered on and in close vicinity to one another for the update to work.

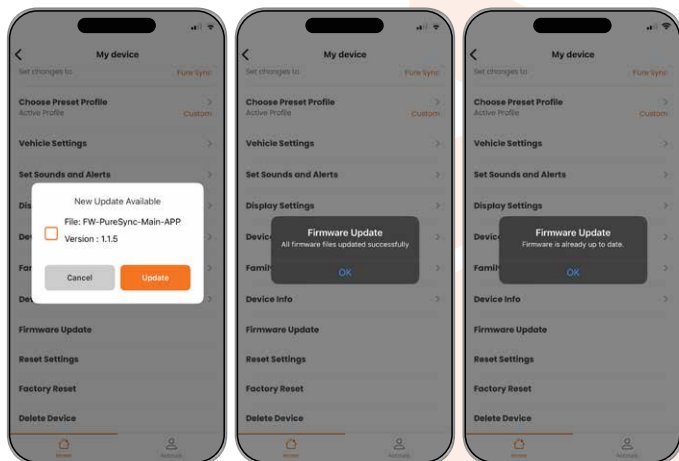

Firmware Update²

Over the Air Updates (OTA)

The Road Angel APP is used to update firmware over the air.



The Pure Sync UI shows firmware update progress and reports when it has been completed.



ROAD ANGEL™



*Product lifetime only and only with active specific subscription

This product is a subscription-based product, for more info please go to www.roadangelgroup.com/subscription or call 0330 320 3030

This product uses a Li-ion battery and should not be left in any direct sunlight or high temperatures.

Please check vehicle compatibility before installation and subscribing.

Vehicle specification and driving variables may cause interference with in-built detection.

Designed, engineered and manufactured by Road Angel Group, DB House, Rani Drive, Nottingham, NG5 1RF, United Kingdom

RoadAngelGroup.co.uk



Product names, logos, brands, and other trademarks featured or referred to within Road Angel Group products and services are the property of their respective trademark holders. These trademark holders are not affiliated with Road Angel Group or our products. They do not sponsor or endorse our materials. The "Apple" name, the Apple logo, iPhone, and iPad are trademarks of Apple Inc., registered in the U.S. and other countries. App Store is a service mark of Apple Inc. The "Android" name, the Android logo, the "Google Play" brand, and other Google trademarks, are property of Google LLC. TM and Copyright 2025 Road Angel. All rights reserved

PURE

